



# 12.8V 200Ah

## LIFEPO4 ENERGY STORAGE BATTERY



Used grade A lifepo4 battery cells



Silver plated copper terminal and fireproof shell materials



More than 6000 times deep cycle, high energy density and environmentally friendly

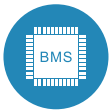

Built-in BMS



Certificate CE, UN38.3, MSDS



IP65 waterproof performance

**UN38.3 MSDS CE**

### Performance Characteristics

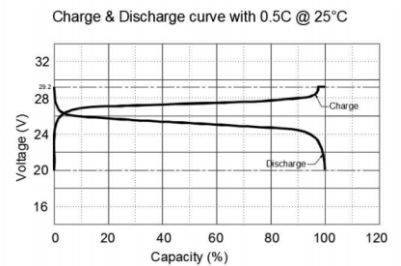
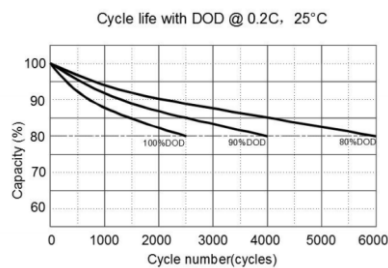

### Parallel connection of batteries

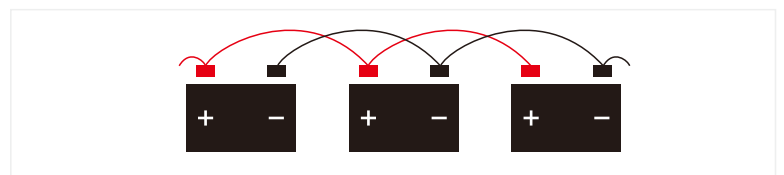

## Features

## RSPS-200AH-12

## Structural parts description

Battery type	Lithium iron phosphate battery pack
Model nominal voltage capacity	FE12200KP \ 12.8v \ 200Ah
Net weight	23KG
Size	Height 240 × Width 170 × Long 490mm
Housing material	ABS plastic
Color	Black
Battery pack combination mode	33174200 4S2P
Cell model and capacity	CATL 33174200 100Ah
<b>Discharge</b>	
Standard discharge current	≤120A
Maximum instantaneous discharge current	≤250A(1s)
Discharge termination voltage	9.2V
Discharge cycle life	6000times(≥80%)
<b>Charge</b>	
Charging mode CC CV	Standard charging: 20A 6 hours Fast charging: 100A 1 hour
Charging voltage	DC 14.6V
<b>Operating temperature requirements</b>	
Charge	0°C---45°C
Normal temperature discharge	0 ° C -- 60 ° C 98% discharge efficiency
Low-temperature discharge	-10 ° C -- 0 ° C 70% discharge efficiency
Keep in storage	-10°C---30°C
<b>PCB board</b>	
Protection control	Overcharge protection value 14.6V Overdischarge protection value 9.2V Overcurrent protection
<b>Battery pack peripherals</b>	
Power display board	LCD display
Charging and discharging port	Special discharge connector for lead shell

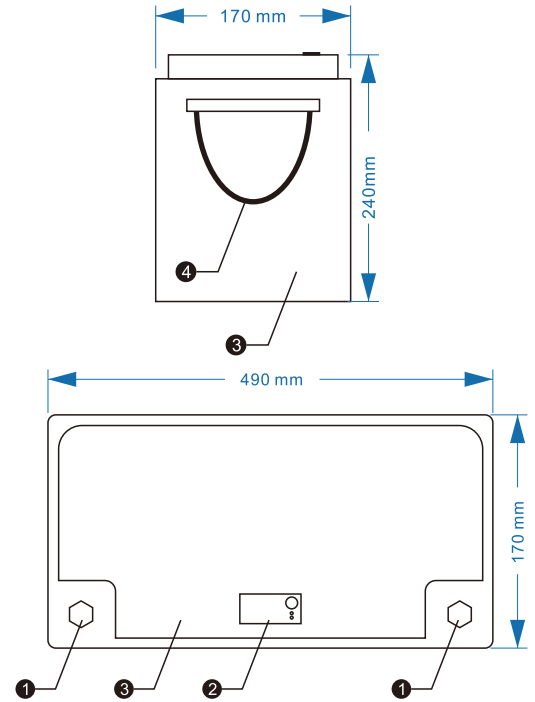

1. M8 screw
2. LED Display
3. ABS plastic shell
4. Portable woven rope

## Structural parts description

